

Land Subsidence: The Lowdown on the Drawdown

The link between groundwater use and sinking landscapes

by Michelle Sneed, USGS Hydrologist



- What is land subsidence, where does it happen, and why does it matter?
- How do weather and land use affect land subsidence in California?
- Why are we optimistic about the future of land subsidence in California?

USGS Menlo Park Campus • **Free Public Lecture** • March 28, 2019 at 7PM

Watch **LIVE** online - online.wr.usgs.gov/calendar

Map for lecture site on reverse

Directions to U.S. Geological Survey

The USGS Menlo Park Campus is located at 345 Middlefield Road in Menlo Park

From San Francisco

- Exit highway 101 at Marsh Road, Atherton
- Go west to the T-junction with Middlefield Rd.
- Turn left (south)

From San Jose

- Exit highway 101 at Willow Road, Menlo Park
- Go west to Middlefield Rd.
- Turn right (north)

Enter the USGS campus at Survey Lane with large stone markers labeled
“U.S. Geological Survey”

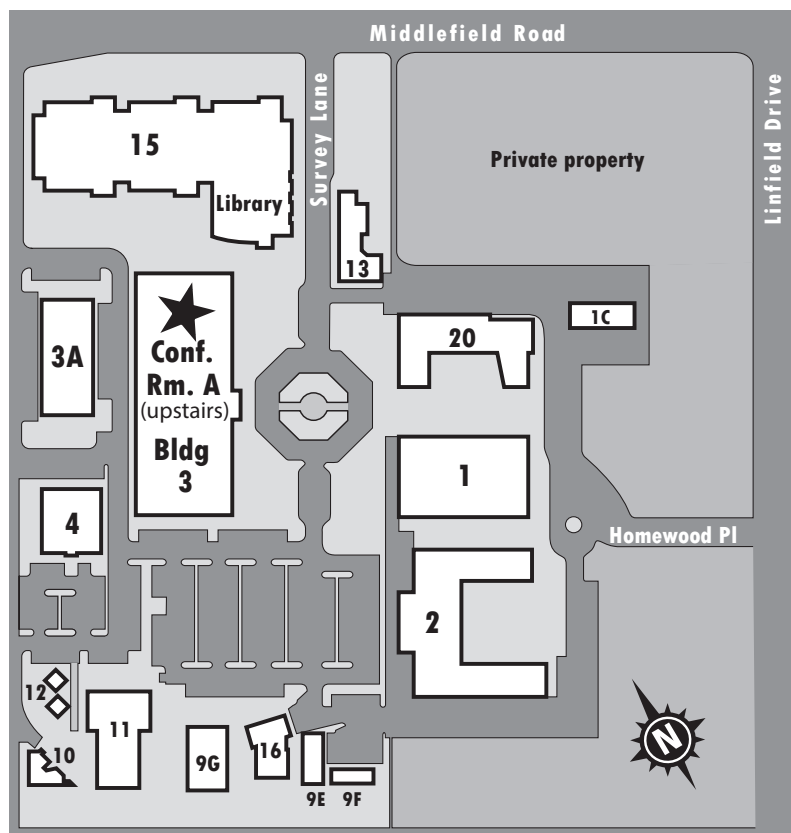
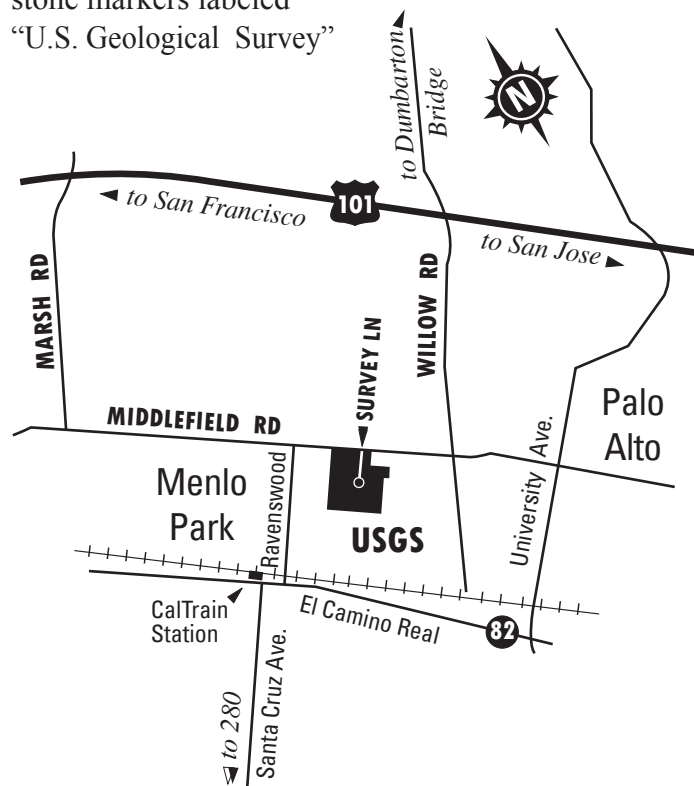

 For special needs accommodation please e-mail wmcesic@usgs.gov, two weeks prior to an upcoming event.

Free USGS Public Lecture

Can't attend in person? Watch LIVE online:

<https://online.wr.usgs.gov/calendar/>

For email announcements: wmcesic@usgs.gov